

IZERWAREN



Tubular Bolt Latches And Dead Bolts For Interior Doors



Privacy latch #18.523



Edition 21

Non Corrosive Fine Building and Ships Hardware
IZERWAREN.COM

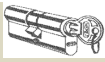

IZERWAREN
Order
numbers

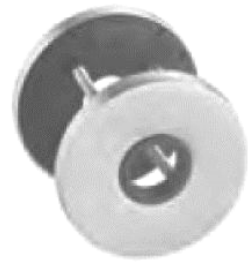

Passage bolt with standard strike
60 mm or 2 3/8 inch backset
70 mm or 2 3/4 inch backset

roses #12.173114

12.723238
12.723234

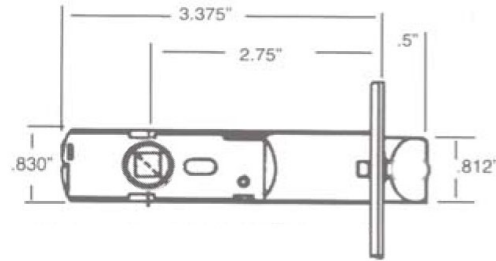
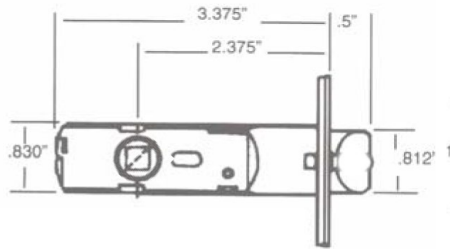

Tubular passage and privacy latch 2 3/8 inch backset

2 3/4 inch backset



Privacy bolt with strike ; pin operated.
60 mm backset or 2 3/8 inch
70 mm backset or 2 3/4 inch

roses #12.173115

12.724238
12.724234



Privacy Bolt; 2 3/8" backset #12.1704 Privacy set square roses #12.1735 Privacy set round roses
with strike box; Roses 55 x 55 mm or 65 x 65 mm see page 1-2-2

12.725238 Dead Bolt 2 3/4" backset with strike box
12.725234 Dead bolt 2 3/8" backset with strike box;

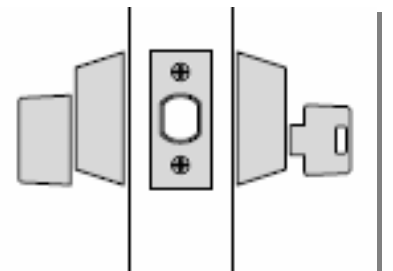
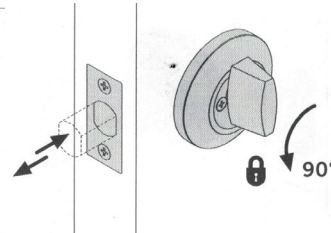
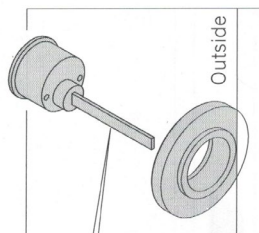

12.238134 #12.238134 Deadbolt with 2 3/8" backset. For standard Key/Thumb-turn setup.

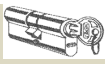

Izerwaren
Order
numbers

- Tubular latch sets; steel parts Interior Grade
- Satin stainless steel
- Mirror Polished stainless steel



12.723238 Passage bolt with standard strike Sample roses #12.173114
 HLL 7230 6204 238 60 mm backset or 2 3/8 inch
 12.723234 HLL 7230 6204 234 70 mm backset or 2 3/4 inch



12.724238 Privacy bolt with strike ; pin operated. Sample roses #12.173115
 HLL 7240 6204 238 60 mm backset or 2 3/8 inch
 12.724234 HLL 7240 6204 234 70 mm backset or 2 3/4 inch

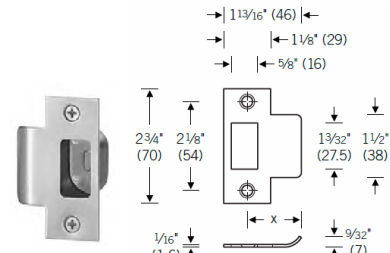

Strike plate #12.1001 stainless steel

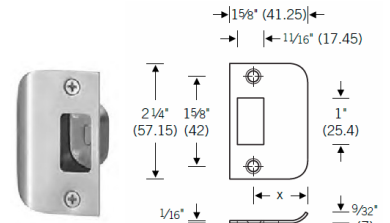

Strike plat #12.1003 stainless steel

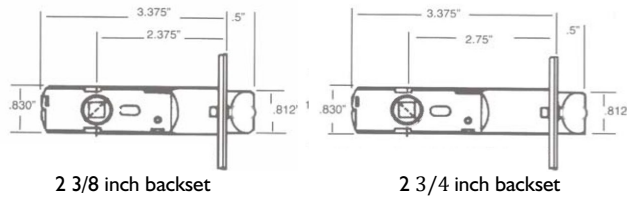

2 3/8 inch backset

2 3/4 inch backset



12.725238 Dead Bolt 2 3/8" backset with strike box; #12.1704 Privacy set square roses
 12.725234 Dead Bolt 2 3/4" backset with strike box



12.725238 Dead bolt 2 3/8 backset with strike box; #12.1735 Privacy set round roses
 12.725234 Dead Bolt 2 3/4 inch backset with strike bolt

HDD 7240 6204 238 60 mm backset or 2 3/8 inch
 HDD 7240 6204 234 70 mm backset or 2 3/4 inch

Function R = one sided - thumb turn only - please specify
 Function S = both sided thumb turn indicator - please specify



#13.3295RS thumb-turn only with square rose
 #13.3296RS indicator only with square rose



#13.3293RF thumb-turn only with round rose
 #13.3294RF indicator only with round rose



Privacy bolt #12.725238 & Thumb-turn set #12.1704
 Passage latch #12.723238
 With rose pair #12.1703 and Lever pair #12.1251
 Satin Stainless Steel Finish



Privacy bolt #12.725238 & Thumb-turn set #12.1735
 Lever #12.1183; Rose #12.173114
 Satin Chrome finish



#12.42311 dummy bolt with blank faceplate;
 for bore hole 3/4 inch hole and 8x8 mm spindle
 One side mounting possible
 Both sides mounting possible
 05 0423 00110

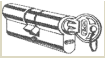

DUMMY SETS



#12.4231 | dummy SET with separate face plate (not shown) roses and lever #12.045



#12.42315 DUMMY SET WITH SQUARE OR ROUND 65 MM ROSES, LEVERS
#12.42313 DUMMY SET WITH SQUARE OR ROUND 55 MM ROSES, LEVERS



#12.42314 SET: DUMMY WITH ESCUTCHEON #12.1410 245X45 MM

KEYWAY/THUMBTURN SET

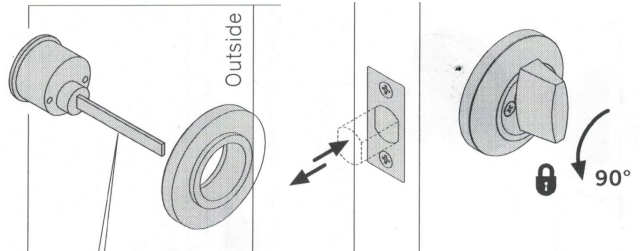
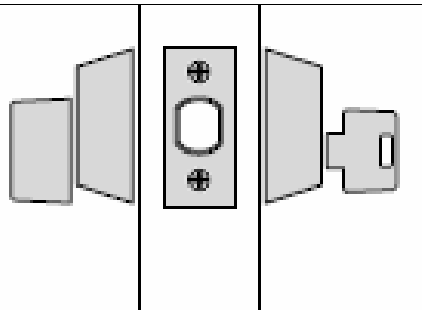

DEADBOLT WITH SCHLAGE KEYWAY #12.238134 BACKSET 2 3/8" FUNCTION KEY/ KNOB

ROSES FOR KEYWAY

DA

03 0450 09011 ■■
2 3/16" (55 mm) x 3/4" (19 mm)

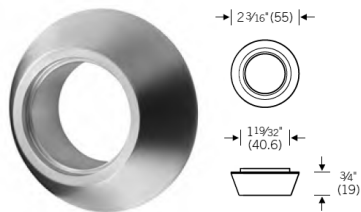

17 1704 12601 ■■

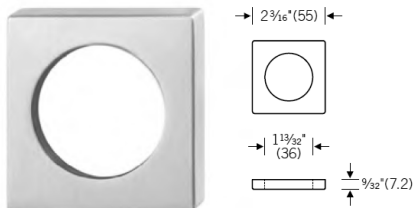

DD

03 0450 09010 ■■
2 3/16" (65 mm) x 3/4" (19 mm)

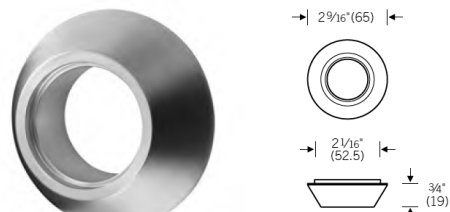

03 0450 09013 ■■
1 3/8" (35 mm) x 3/16" (5 mm)

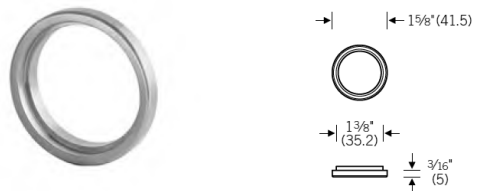

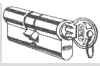

Passage latch 2 3/8 inch backset
18.011 for Levers
18.013 for Knobs

Passage latch 2 3/4 inch backset
18.012 for Levers
18.014 for knobs

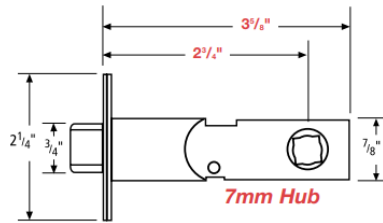
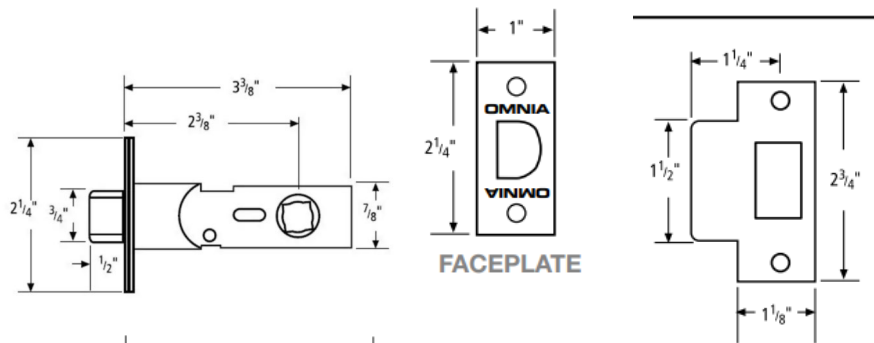

Hub: for 7 x 7 mm spindle

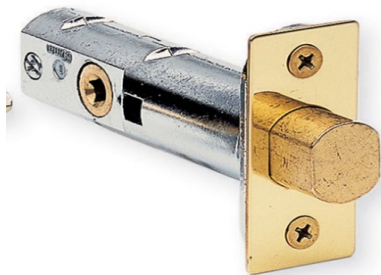
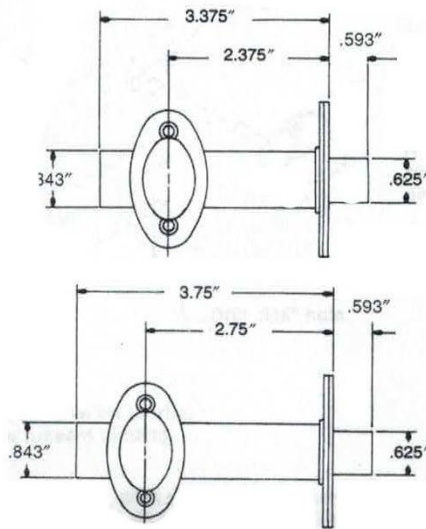

18.455 Privacy Bolt
065/238 with 2 3/8 inch
backset

18.4557 Privacy Bolt
065/234 with 2 3/4 inch
backset

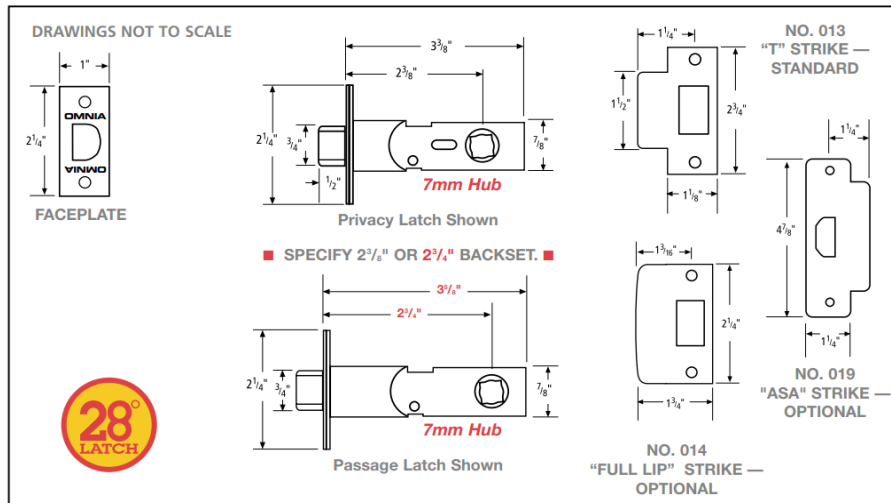



DRAWINGS NOT TO SCALE

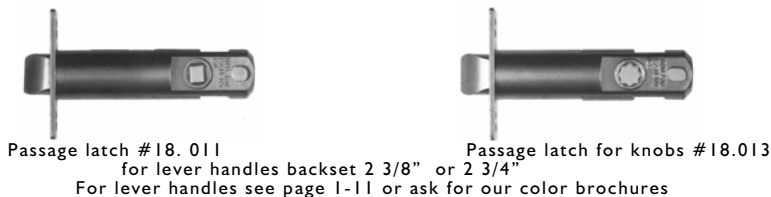
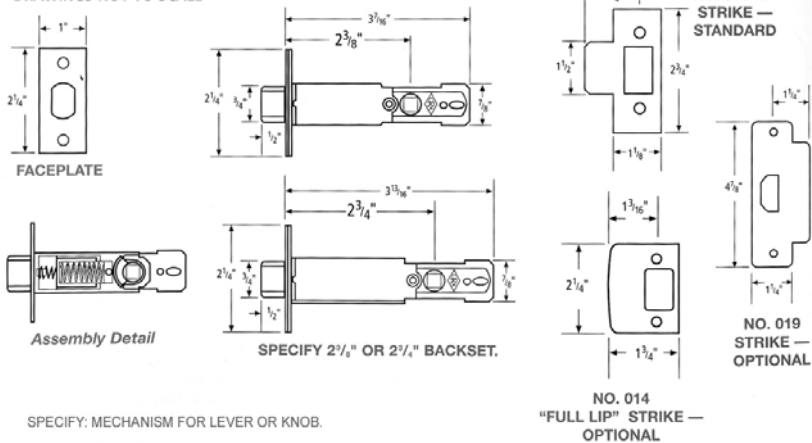

Lever with roses set specify 18.752 passage or privacy

See also page 1-11 and the Izerwaren Trim Brochure for more lever designs



#18.455 tubular privacy bolt.

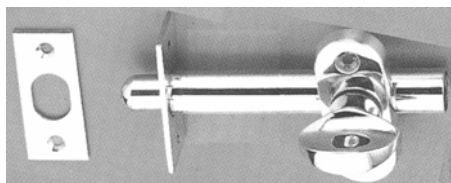

Privacy turning bolt #18.017 with oblong escutcheon thumb-turn inside, indicator outside.

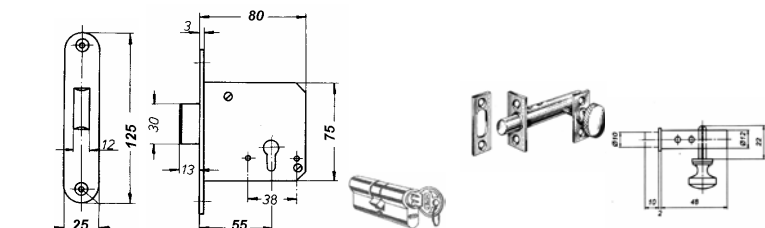

- Izerwaren Order numbers
- Steel tubular latches, backset 2 3/8 - 2 3/4"
 - Not recommended for marine use
 - Minimum door thickness: 32 mm - 1 1/4"
 - Square corners on lock & strike plate
 - Strike plate included with lock
 - Brass tubular privacy bolt, backset 2 3/8 - 2 3/4"; to fit with tubular latch
 - Specify finish:
 - BPC polished chrome plated brass
 - BP polished brass

- 18.011 **Passage tubular Latch bolt (6011)** backset 2 3/8"
For lever handles
Tubular bolt 15/16" diameter
For 7x7 mm spindle for door lever handles strike plate included
- 18.012 **Passage tubular Latch bolt (6012)** backset 2 3/4"
For lever handles
Tubular bolt 15/16" diameter
For 7x7 mm spindle for door lever handles strike plate included
- 18.013 **Passage tubular latch bolt (6013)** backset 2 3/8"
For knobs
Tubular bolt 15/16" diameter
For 7x7 mm spindle for door lever handles strike plate included

- 18.014 **Passage tubular latch bolt (6014)** backset 2 3/4"
For knobs
Tubular bolt 15/16" diameter
For 7x7 mm spindle for door lever handles strike plate included

- 18.752 **Lever with roses 2 3/8 diameter with tubular latch**
Roses 2 3/8"; backset 2 3/8"
With 7x7 mm spindles strike plate included

- 18.455 **Privacy bolt separate, tubular** backset 2 3/8 or 2 3/4
Tubular bolt 1" diameter
With 5 x 5 mm spindle, thumb-turn in side, indicator outside roses 1 3/4 inch diameter strike plate included
Material: Brass

- 18.017 **Privacy tubular bolt = 2 3/8"**
18.018 **Privacy tubular bolt = 2 3/4"**
With oblong escutcheon for narrow style

14.72Z **FOR KEY LOCK WE RECOMMEND A BRASS MORTISE DEAD BOLT:** (sea also page 1-4)

- 14.17Z **Dead Bolt Mortise Lock (1172Z)**
Case: 80 mm x 75 mm x 16 mm thick
Front plate 125 x 25 mm
Works with Profile Cylinder Key Way

- 14.241 **Strike plate (3241)**
05.405 **Profile cylinder #1400 series** see page 1-5

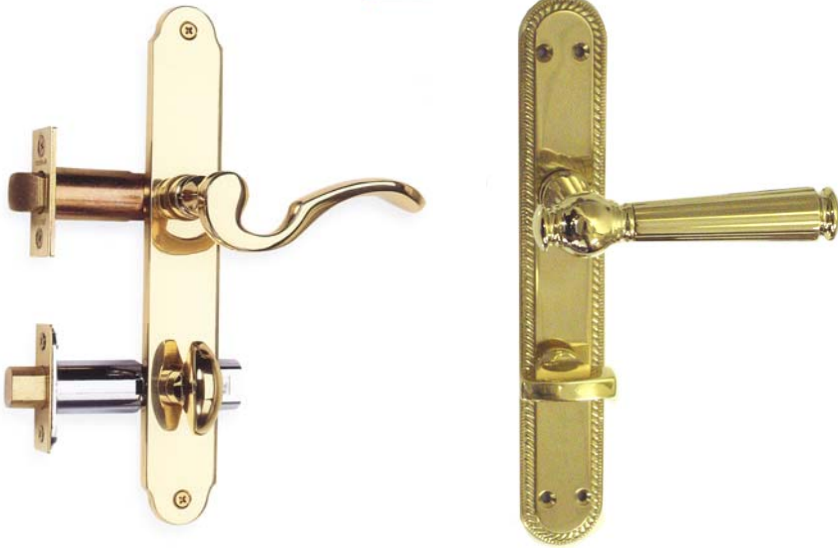

Showing mechanism for levers #18.014 Escutcheon #840 Lever #949; Privacy Set shown with thumb-turn #4005 mechanism for dead bolt 18.455

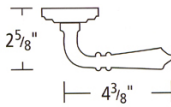

Sample Lever with roses set specify 18.752 passage or privacy

See also page 1-11 and the Izerwaren Trim Brochure for more lever designs



#18.455 tubular privacy bolt.

NOTE: all steel parts, not recommended for marine use or coastal environment.

Izerwaren Order numbers

- Steel tubular latches, backset 2 3/8 - 2 3/4"
- Not recommended for marine use
- Minimum door thickness: 32 mm - 1 1/4"
- Square corners on lock & strike plate
- Strike plate included with lock
- Brass tubular privacy bolt, backset 2 3/8 - 2 3/4"; to fit with tubular latch
- Specify finish:
 - BPC polished chrome plated brass
 - BP polished brass

18.011 **Passage tubular Latch bolt (6011)** backset 2 3/8" For lever handles Tubular bolt 15/16" diameter For 7x7 mm spindle for door lever handles strike plate included

18.012 **Passage tubular Latch bolt (6012)** backset 2 3/4" For lever handles Tubular bolt 15/16" diameter For 7x7 mm spindle for door lever handles strike plate included

18.013 **Passage tubular latch bolt (6013)** backset 2 3/8" For knobs Tubular bolt 15/16" diameter For 7x7 mm spindle for door lever handles strike plate included

18.014 **Passage tubular latch bolt (6014)** backset 2 3/4" For knobs Tubular bolt 15/16" diameter For 7x7 mm spindle for door lever handles strike plate included

18.752 **Lever with roses 2 3/8 diameter with tubular latch** Roses 2 3/8"; backset 2 3/8 With 7x7 mm spindles strike plate included

18.455 **Privacy bolt separate, tubular** backset 2 3/8 or 2 3/4 Tubular bolt 1" diameter With 5 x 5 mm spindle, thumb-turn in side, indicator outside roses 1 3/4 inch diameter strike plate included Material: Brass

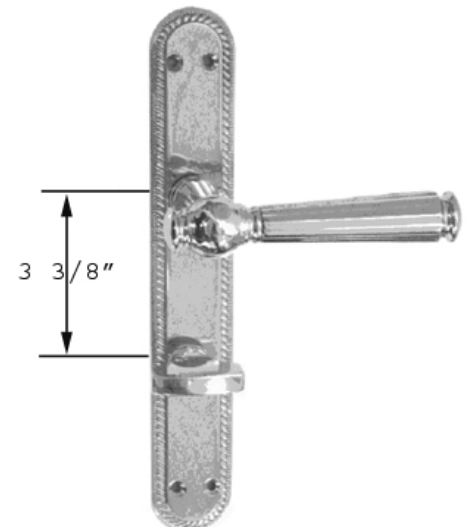

Escutcheon #840 Lever #949; Privacy Set shown with thumb-turn #4005

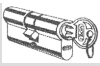

Passage latch 2 3/8 inch backset
18.513P for Levers
18.510P for Knobs

Privacy latch 2 3/4 inch backset
18.520P for Levers
18.523P for Knobs

Passage latch 2 3/4 inch backset
18.520P for Levers
18.523P for Knobs

Privacy latch 2 3/8 inch backset
18.513P for Levers
18.510P for Knobs

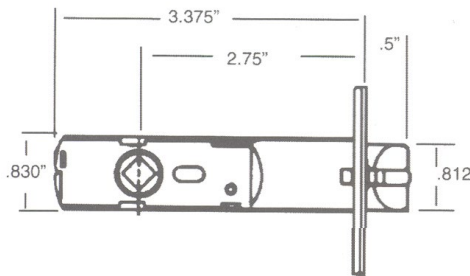
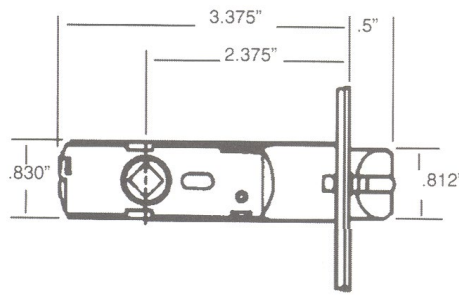

Function: Passage latch: Open door from both sides
Function: Privacy latch with anti-panic emergency release

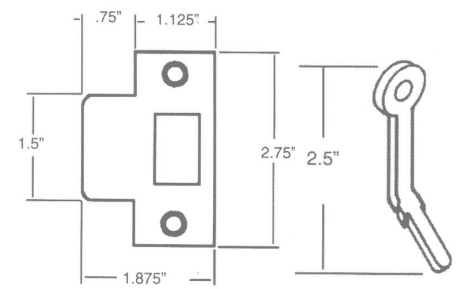

Strike plate and emergency release pin for privacy function



Mortise bolt 2 3/8 inch backset # 18.418
Mortise bolt 2 3/4 inch backset # 18.413

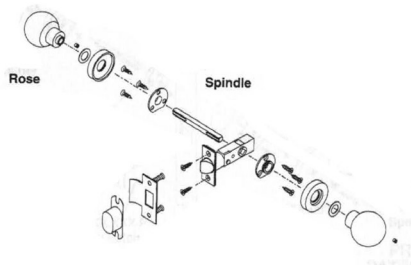
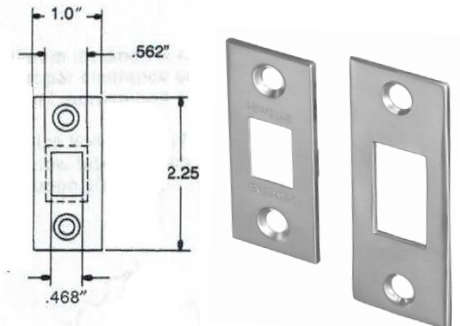
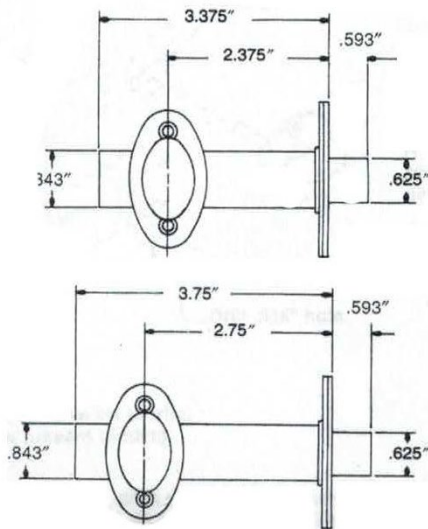

Passage setup diagram

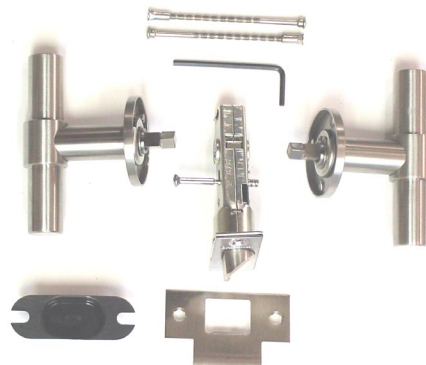

Privacy set up diagram Euro levers

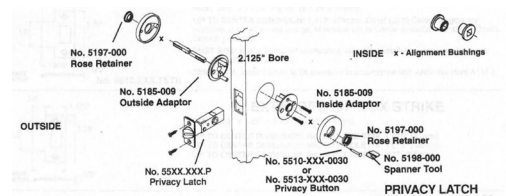

Privacy diagram USA

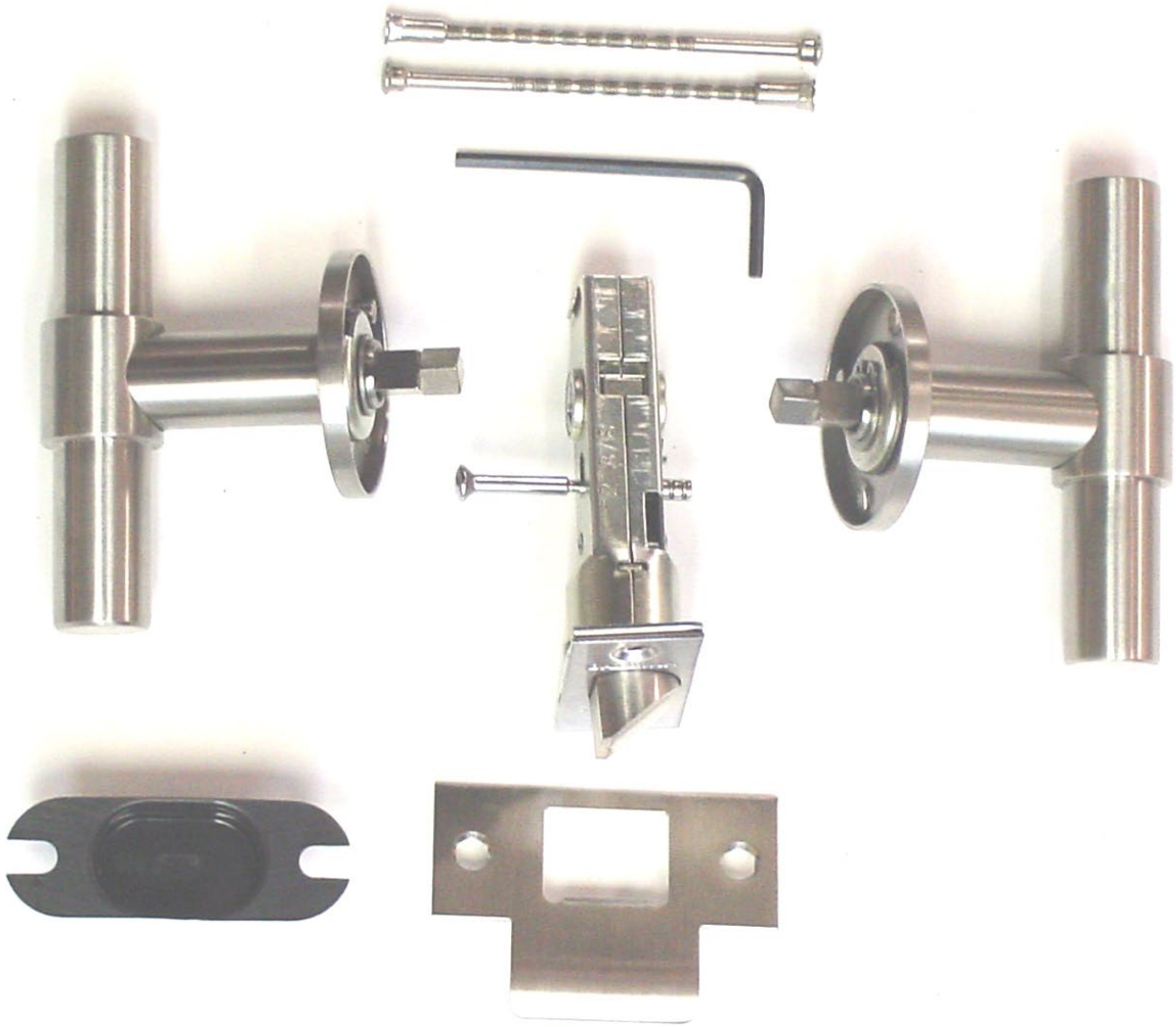

PRIVACY SET UP EUROPEAN LEVERS WITH 8X8 MM SPINDLE

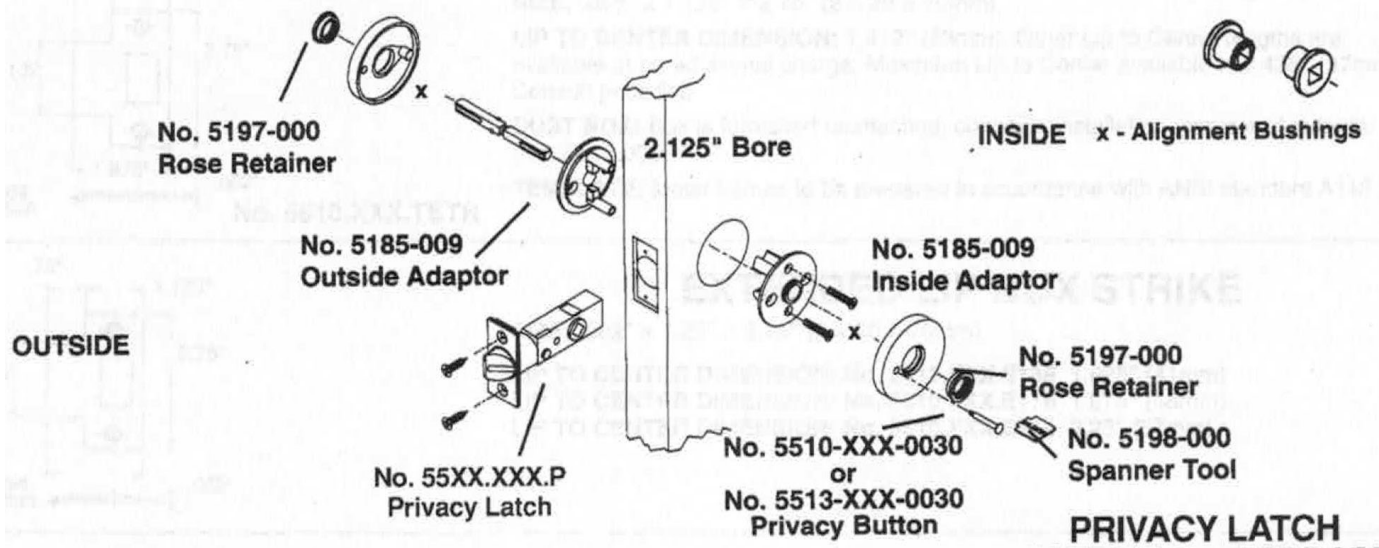

PRIVACY DIAGRAM SETUP US



Pocket door locks for door thickness 1 3/8" and up



#13.FE2348T
Size: Outside: 2 13/16" x 2 1/4" x 11/32"

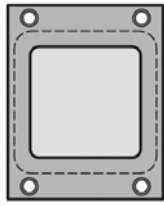

#13.FE2348B

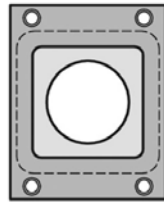

#13.2348C

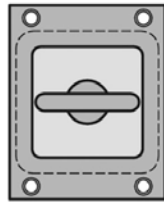

#13.FE2348T

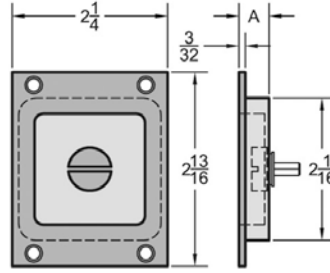

#13.FE2348E
A = 11/32"



Trim set
Flush square plate #13.SBT
Mechanism+ edge pull #13.002
Satin nickel



#13.R161T
Size: Outside: 2 3/8" diameter. Drill Hole: 2 1/8"

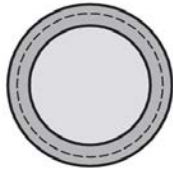

#13.R161B (pair)

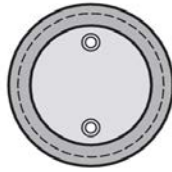

#13.R161T



#13.R161E

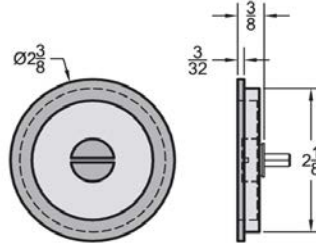

#13.S161T
Size: Outside: 3 1/4" x 2 3/8". Drill Hole: 2 1/8"

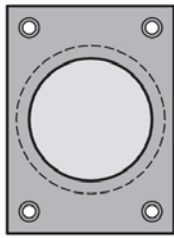

#13.S161B (pair)

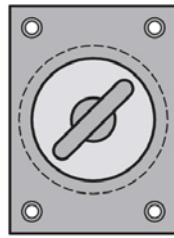

#13.S161T

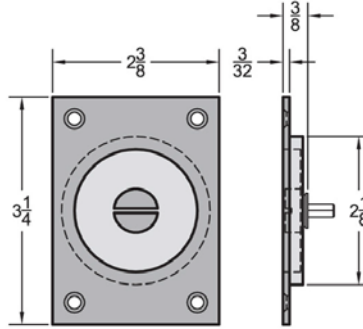

#13.S161E



Trim set
Flush Round plate #13.161E
Mechanism+ edge pull #13.002
Satin nickel



Hook Mechanism for pocket doors #13.161PDL
Specify backset: 2 3/4" or 2 3/8" Specify finish.

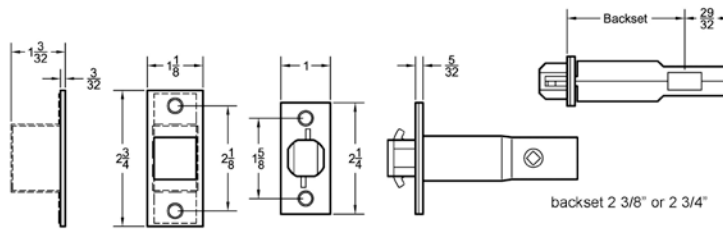

Trim set
Flush Round plate #13.161E
Mechanism #13.161PDL
Satin brass



Edge pull Mechanism for pocket doors #13.161PDP
Case: 1" diameter; Pull 5/8" diameter; spring loaded. Specify finish.

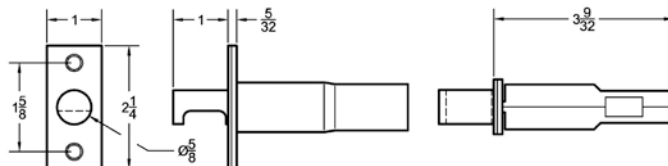

Trim set
Flush Round plate #13.161T
Mechanism #13.161PDL
Satin brass